

Combined Sounder/Detector/Visual Indicator Installation Guide

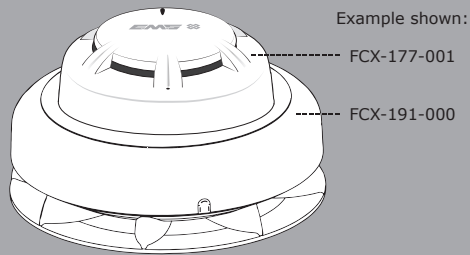

Part No	Product Description	CPR
FCX-174-001	Multisensor Smoke Detector Only	[1]
FCX-175-001	Heat A1R Detector Only	[2]
FCX-176-001	Heat CS Detector Only	[2]
FCX-177-001	Optical Smoke Detector Only	[3]
FCX-191-000	Sounder/Detector Base Only	[4]
FCX-191-100	Sounder/Detector/Clear Visual Indicator Base Only	[4]
FCX-191-200	Sounder/Detector/Red Visual Indicator Base Only	[4]

See the Specification section for compliance information.

1 Pre Installation



Installation must conform to applicable local installation codes and should only be installed by a fully trained competent person.

- Ensure that the device is installed as per the site survey.
- The use of a non-metallic spacer should be considered if mounting the device on to a metal surface.
- Do NOT Press the Log On button on a pre-programmed device, as this will cause communication with the Control Panel to be lost. Should this happen, delete the device from the system and add it back on.

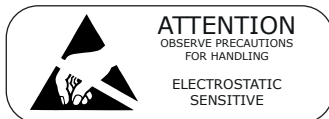

2 Components

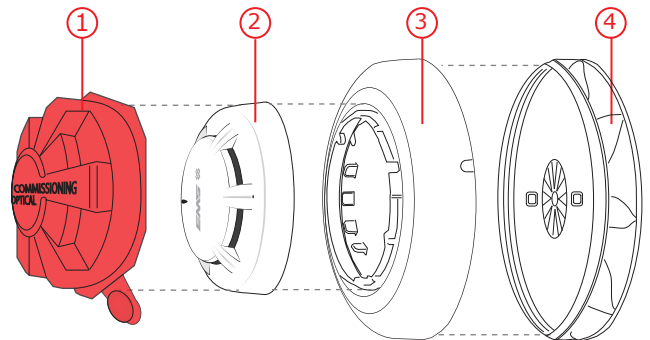

① Dust Cover ② Detector ③ Wireless Module ④ Mounting Plate

3 Fix Mounting Plate

Remove the mounting plate from the wireless module by turning it anticlockwise.

- Use both mounting holes to ensure a firm fixing.
- Use suitable fasteners and fixings.

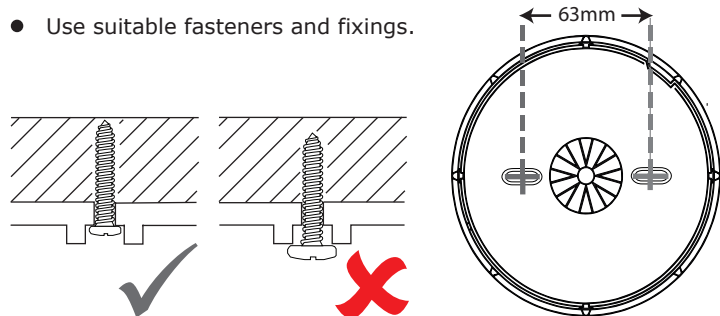

4 Power Device

- When fitting / replacing batteries; observe correct polarity, using only specified batteries.
- Set switch 1 to the ON position to power the device. See the configuration section for other available switch settings.

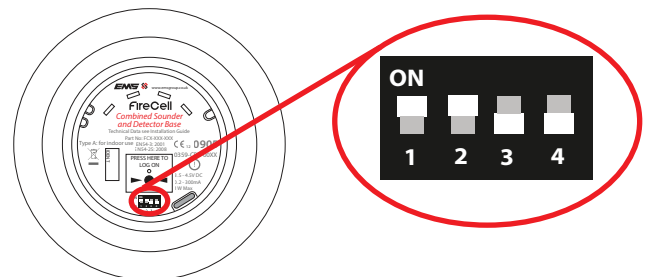

- Once powered, reassemble the device.

5 Optional Device Locking

- To lock the detector into the wireless module, remove the cut out (shaded) section as shown.
- To unlock the detector, insert a 1.5mm Allen key and lever the Allen key towards the outside of the device and turn the detector anticlockwise to release.
- The wireless module can also be locked into the mounting plate by removing the shaded section shown and fitting a 5/16 Phillips pan head screw.

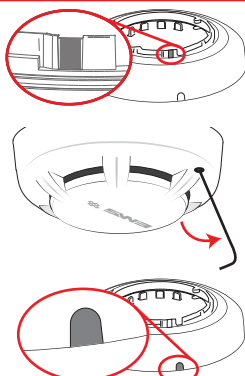

6 Configuration

The device's loop address is configured within the menu structure of the Radio Hub.

- Refer to the programming manual (Doc Ref: MK98) for full programming information.



Free to download from www.emsgroup.co.uk

Configuration Continued

Device Powering/Sounder Volume (Set on Wireless Module)

Switches 1-2 on the 4 way switch are used to power the device and to change the sounder volume.

Default Setting: Supplied unpowered with high sounder volume.

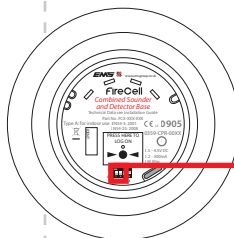

SWITCHES 1 & 2	DEVICE POWERED?	SOUNDER VOLUME
ON ON	✓	HIGH 87dB A (+/- 1dB)
ON OFF	✓	LOW 74 dB A (+/- 1dB)
OFF ON	✗	HIGH 87dB A (+/- 1dB)
OFF OFF	✗	LOW 74 dB A (+/- 1dB)

Sounder Tone (Set on Wireless Module)

Switches 3-4 on the 4 way switch are used to configure the sounder tone.

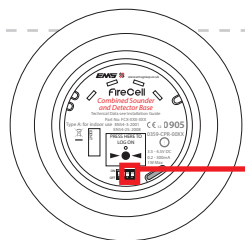

SWITCHES 3 & 4	PRIMARY TONE	TONE TYPE	TONE DESCRIPTION / APPLICATION	SECONDARY TONE	TONE TYPE	TONE DESCRIPTION / APPLICATION
ON OFF	1	—	970Hz	18	—	2400Hz
OFF ON	2		800Hz/970Hz @ 2Hz	1	—	970Hz
ON ON	3		800Hz - 970Hz @ 1Hz	1	—	970Hz
OFF OFF	5		970Hz, 0.5s / 630Hz, 0.5s	4	—	970Hz 1s OFF / 1s ON

Default Setting: Primary Tone 5

IMPORTANT

- Remove dust cover before use.
- The device should be tested upon installation and in accordance with local requirements.
- Testing should only be carried out by a fully trained competent person.

- The Manufacturer recommends regular functional testing of at least once per annum or in accordance with local codes of practice.
- Cleaning and repairs must be undertaken by the Manufacturers authorised representative.
- Do not open the case to clean inside the detector.

Specification

Operating Temperature	-10°C to 55°C
Storage Temperature	5°C to 30°C
Humidity	Up to 95% non-condensing
Supply	3x AA Alkaline (Panasonic LR6AD Powerline / Varta 4006 Industrial) & 3x C Alkaline (Panasonic LR14AD Powerline / Varta 4014 Industrial)
CAUTION! Fitting of an incorrect battery type invalidates the product certification and may result in poor performance.	
IP Rating	IP23
Operating Frequency	868MHz
Output Transmitter Power	Auto adjusting 0 - 14 dBm (0 - 25 mW)
Sounder Output [4]	87dB(A) @ 1m (as dispatched). Low setting reduces volume by 13dB. Refer to the sounder data document (MK187) for full details. <i>Free to download from www.emsgroup.co.uk</i>
Dimensions	146mm (Ø) x 53mm (D) (No detector) 146mm (Ø) x 89mm (D) (with smoke detector) 146mm (Ø) x 94mm (D) (with heat detector) 146mm (Ø) x 100mm (D) (with multisensor detector)
Weight	0.70kg (with detector)
Location	Type A: For indoor use

Regulatory Information

Manufacturer	EMS Ltd. Technology House, Herne Bay, Kent, CT6 8JZ, United Kingdom
Year of manufacture	See devices serial number label
Certification	CE 20 ^[1] CE 10 ^{[2][3]} CE 12 ^[4]
Certification body	0905
CPR Certificate DoP	See part listing for associated products: ^[1] 0905-CPR-202126, ^[2] 0359-CPR-0015, ^[3] 0359-CPR-0017 & ^[4] 0359-CPR-0121
Approved to	See part listing for associated products: EN54-3:2001. Incorporating Amendments Nos. 1 and 2. Fire detection and fire alarm systems. Part 3: Fire alarm devices - Sounders. ^[4] EN54-5:2001. Incorporating Amendment No. 1. Fire detection and fire alarm systems. Part 5: Heat detectors - Point Detectors. ^[2] EN54-7:2001. Incorporating Amendment No. 1. Fire detection and fire alarm systems. Part 7: Smoke detectors - Point detectors using scattered light, transmitted light or ionization. ^{[1][3]} EN54-25:2008. Incorporating corrigenda September 2010 and March 2012. Fire detection and fire alarm systems. Part 25: Components using radio links. ^[4]
European Union directives	EMS declares that the radio equipment type FireCell Combined Sounder/Detector/Visual Indicator variants are in compliance with Directive 2014/53/EU. The full text of the EU declaration of conformity is available at the following internet address: www.emsgroup.co.uk 2012/19/EU (WEEE directive): Products marked with this symbol cannot be disposed of as unsorted municipal waste in the European Union. For proper recycling, return this product to your local supplier upon purchase of equivalent new equipment, or dispose of it at designated collection points. For more information see www.recyclethis.info Dispose of your batteries in an environmentally friendly manner according to your local regulations.